

MAR

ASPIRATORE VENTILATORE CENTRIFUGO
CENTRIFUGAL FAN

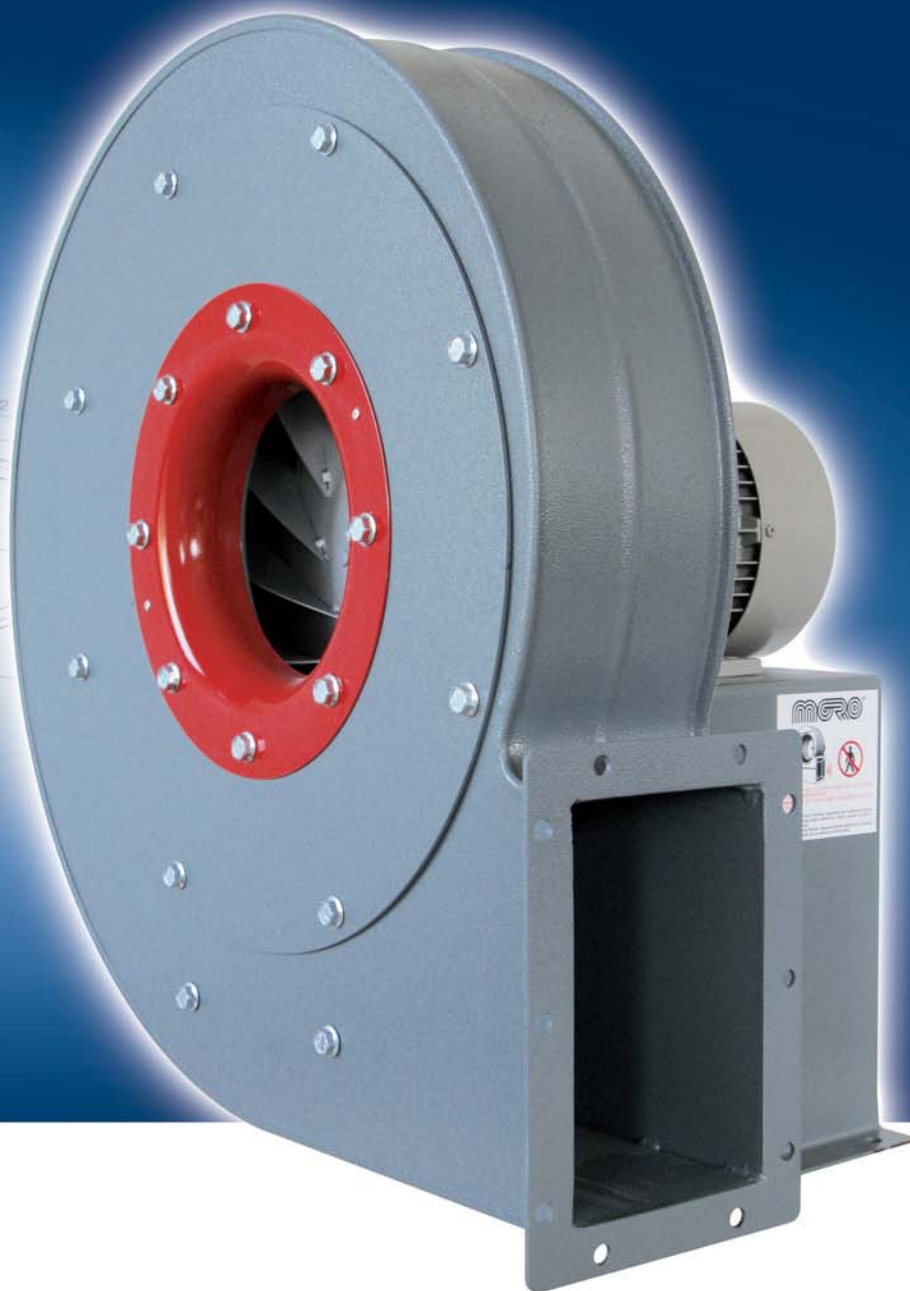

GIRANTE A PALE CURVE ROVESCE
BACKWARD CURVED BLADES IMPELLER



ALTA PRESSIONE
HIGH PRESSURE

Portata/Flow rate:
300 ÷ 15000 m³/h

Pressione/Pressure:
50 ÷ 900 mm H₂O



MAR

ASPIRATORE VENTILATORE CENTRIFUGO CENTRIFUGAL FAN



I ventilatori della serie MAR sono indicati per l'utilizzo in tutti i campi in cui siano necessarie portate relativamente piccole con pressioni elevate di aria pulita o leggermente polverosa.

L'esecuzione standard prevede l'utilizzo di coclee con profili ibordati, telaio di base, giranti a pale rovesce tutti in acciaio al carbonio verniciati e l'installazione di motori elettrici a 2 poli.

I fluidi trasportati possono raggiungere una temperatura massima di 80°C in esecuzione standard; nel caso di esecuzioni speciali, sono ammessi valori massimi di 180°C. A richiesta sono disponibili esecuzioni in acciaio inossidabile; i ventilatori della serie MAR sono fornibili anche in conformità alla direttiva ATEX (2014/34/UE).

MAR series blowers are suitable for all applications requiring quite small flow rates with high pressures of clean or slightly dusty air. Standard execution blowers are provided with edged steel sheets casings, carbon steel base frames, radial blades painted impellers and 2 poles electrical motors.

Transported fluids can reach maximum temperature of 80°C for standard execution; for special executions maximum values of 180°C are allowed. On demand, special stainless steel execution are available; MAR blowers are available also according to ATEX directive (2014/34/EU).

Esecuzione 4 (con basamento) - Arrangement 4 (with base frame)

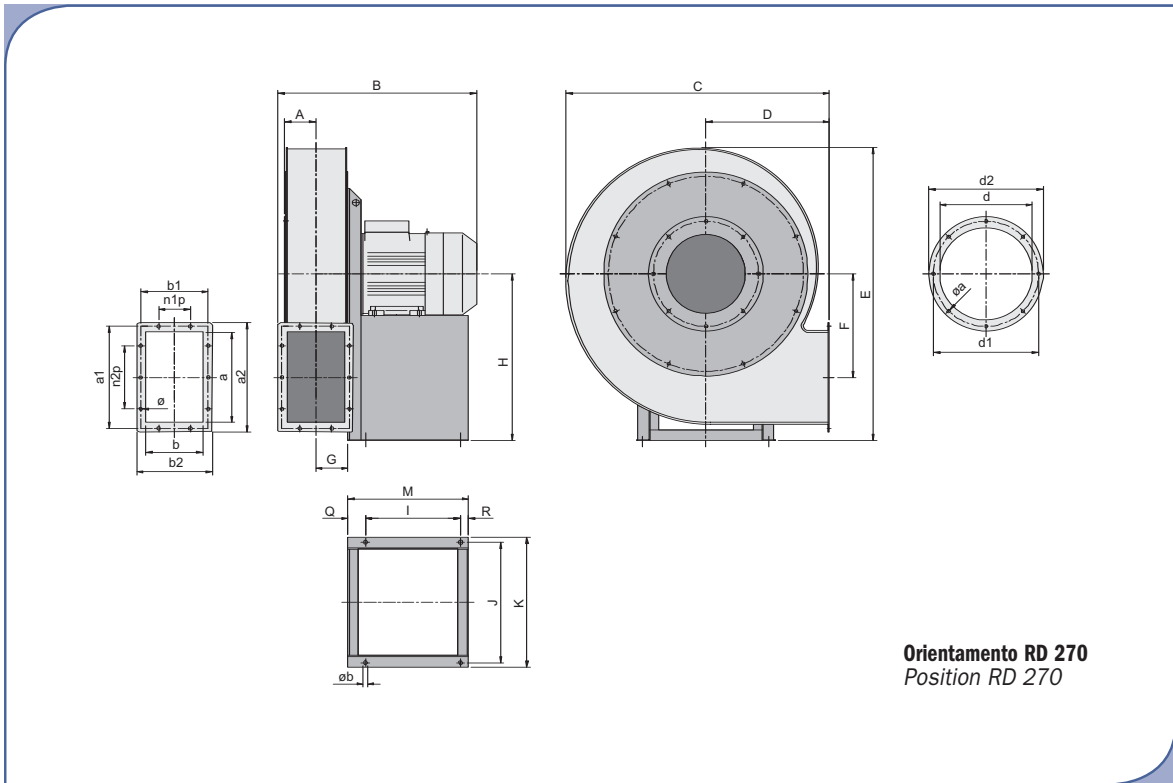

Direzioni di rotazione (vista lato motore) - Rotation senses (seen from motor side)

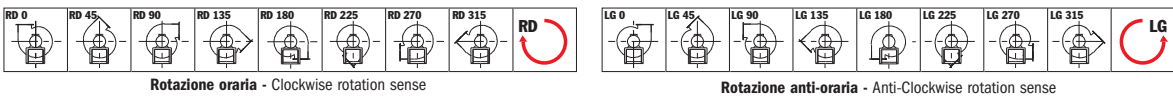

Esecuzione 5 - Arrangement 5

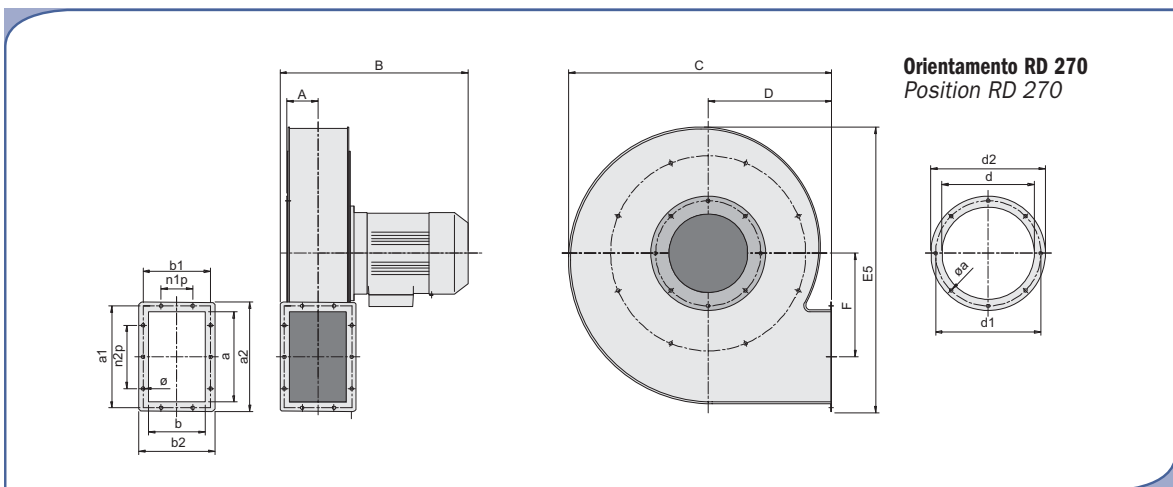

Direzioni di rotazione (vista lato motore) - Rotation senses (seen from motor side)

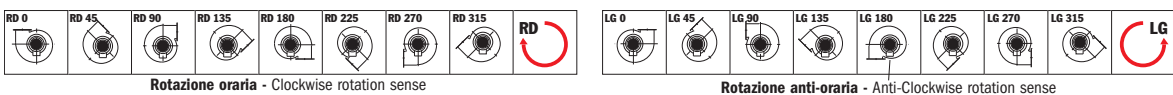

DIMENSIONI D'INGOMBRO

OVERALL DIMENSIONS



Peso ventilatore in Kgf (completo di motore) - Weight of ventilator (complete with motor)

NOTA: quota B indicativa - NOTE: "B" quote indicative

TIPO - TYPE		kW inst.	PESO WEIGHT	VENTILATORE FAN								
VENTILATORE FAN	MOTORE MOTOR			kgf	A	B	C	D	E	E5	F	G
MAR 310	71 M2	0,55	29	58	350	470	220	540	515	182	58	312
MAR 350	80 M2	1,1	36	61	395	530	250	597	577	207	61	342
MAR 400	90 S2	1,5	44	70	430	588	275	674	648	233	70	387
MAR 450	100 L2	3	52	78	455	650	306	730	711	255	78	417
MAR 501	112 M2	4	120	88	505	738	350	827	800	288	88	472
MAR 502	132 S2	5,5			535							
MAR 571	132 S2	7,5	210	98	555	828	390	925	898	327	98	527
MAR 572	160 M2	11			675							
MAR 631	160 M2	11	270	108	695	940	448	1028	676	368	108	582
MAR 632	160 L2	15			800							
MAR 711	160 L2	18,5	375	120	720	1048	500	1150	756	415	120	652
MAR 712	180 M2	22			760							
MAR 713	200 L2	30			800							

TIPO - TYPE	FLANGIA ASPIRANTE INLET FLANGE					FLANGIA PREMENTE OUTLET FLANGE										BASAMENTO BASE														
	VENTILATORE FAN	d	d ₁	d ₂	n°	∅	a	b	a ₁	b ₁	a ₂	b ₂	n ₁ xp	n ₂ xp	n°	∅	I	J	K	L	M	N	O	P	Q	R	S	T	U	∅ _b
MAR 310		168	200	235	8	11	160	101	194	135	210	156	1x90	1x90	8	11	135	230	260	-	210	-	-	-	50	25	-	-	-	11
MAR 350		187	219	254	8	11	179	111	213	147	230	165	1x90	1x90	8	11	175	240	270	-	250	-	-	-	50	25	-	-	-	11
MAR 400		209	241	278	8	11	202	125	235	161	256	180	1x90	2x90	10	11	175	290	320	-	250	-	-	-	50	25	-	-	-	11
MAR 450		233	265	300	8	11	226	141	259	176	286	200	1x90	2x90	10	11	225	290	320	-	305	-	-	-	55	25	-	-	-	13
MAR 501		260	292	327	8	11	253	160	286	194	313	220	1x90	2x90	10	11	300	350	390	-	380	-	-	-	55	25	-	-	-	13
MAR 502																														
MAR 571		300	332	362	8	11	285	180	322	213	345	240	1x100	2x100	10	11	300	400	440	-	380	-	-	-	55	25	-	-	-	13
MAR 572																														
MAR 631		350	382	410	8	11	320	200	356	235	380	260	1x100	3x100	12	11	420	440	480	-	500	-	-	-	55	25	-	-	-	13
MAR 632																														
MAR 711		350	382	410	8	11	358	224	395	265	428	294	1x100	3x100	12	11	470	480	520	-	550	-	-	-	55	25	-	-	-	13
MAR 712																														
MAR 713																														



DIRETTAMENTE ACCOPPIATI CON MOTORE A 2 POLI

DIRECT CONNECTION FOR 2 POLES MOTORS

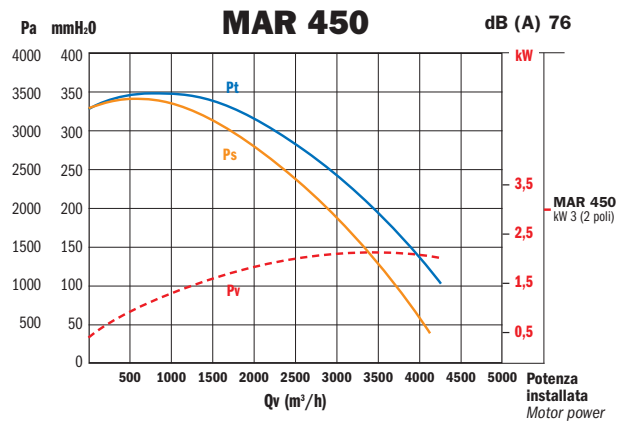
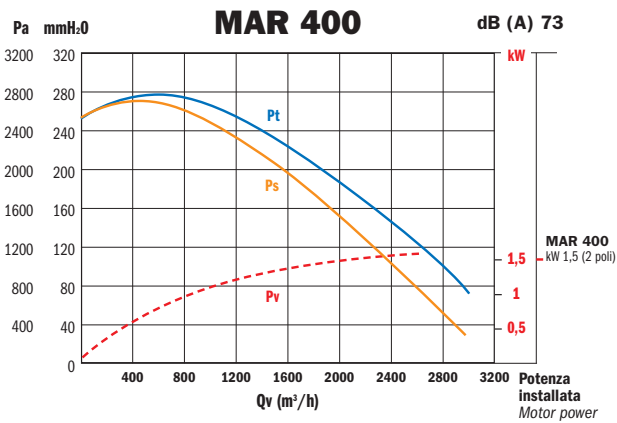
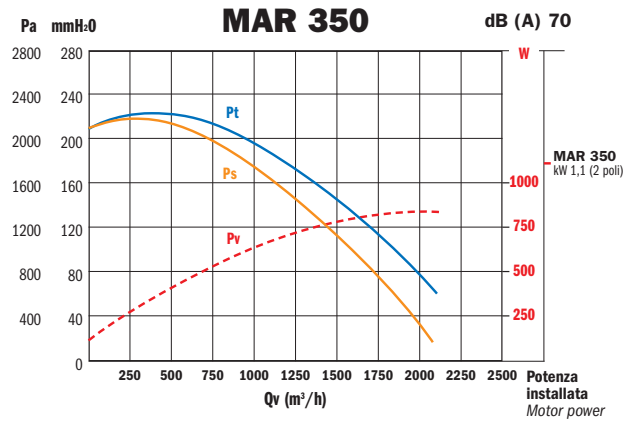
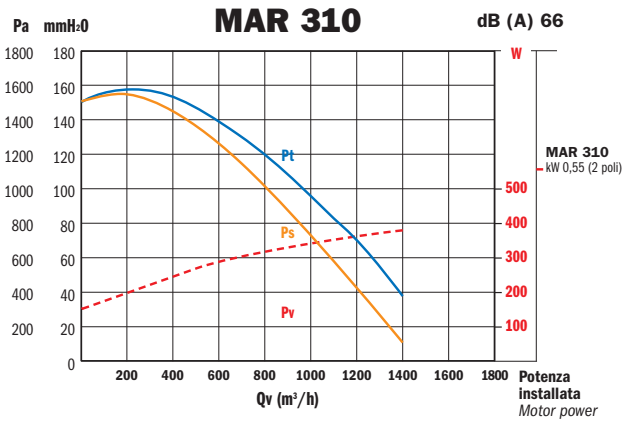

Valori riferiti a: / Datas referring to: T=15°C; P=1 atm

— Pt= Pressione totale - Total pressure — Ps= Pressione statica - Statical pressure - - - Pv= Potenza assorbita - Absorbed power

DIRETTAMENTE ACCOPPIATI CON MOTORE A 2 POLI

DIRECT CONNECTION FOR 2 POLES MOTORS

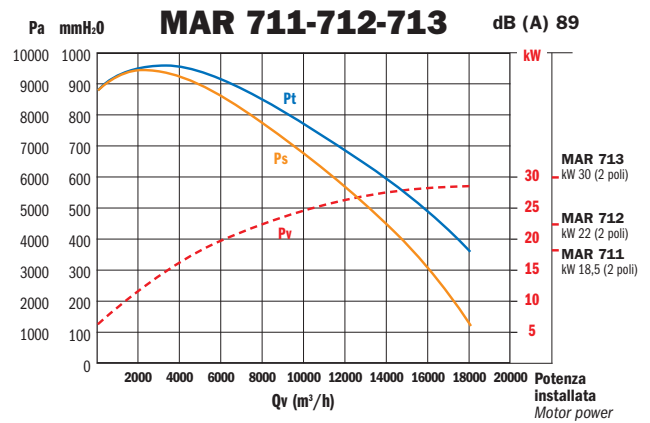
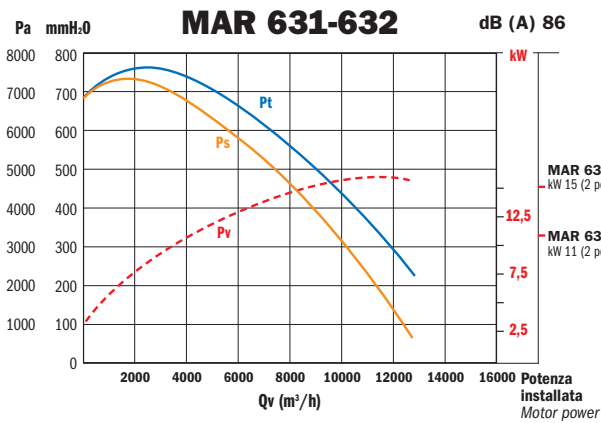
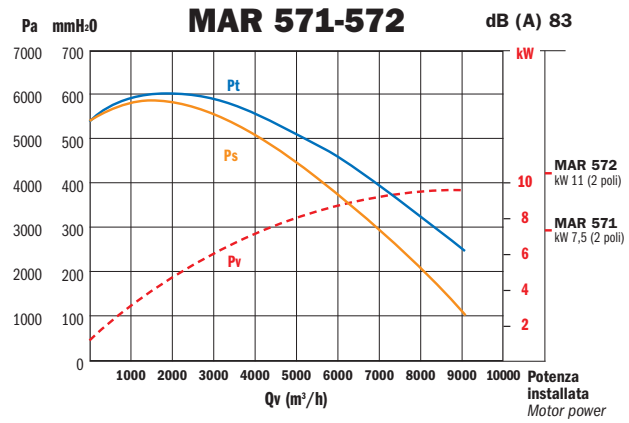
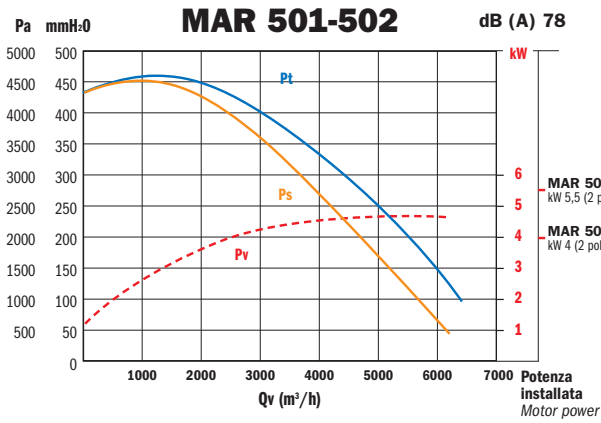

Valori riferiti a: / *Datas referring to:* T=15°C; P=1 atm

— Pt= Pressione totale - Total pressure — Ps= Pressione statica - Statical pressure - - - Pv= Potenza assorbita - Absorbed power